

NORTH ↑

NOT A LEGAL SURVEY

1"=40ft

Print to be 17"x11" for scale

LEGEND

- ◆ Observation Ports
- ▲ Benchmark

**APPROVED**

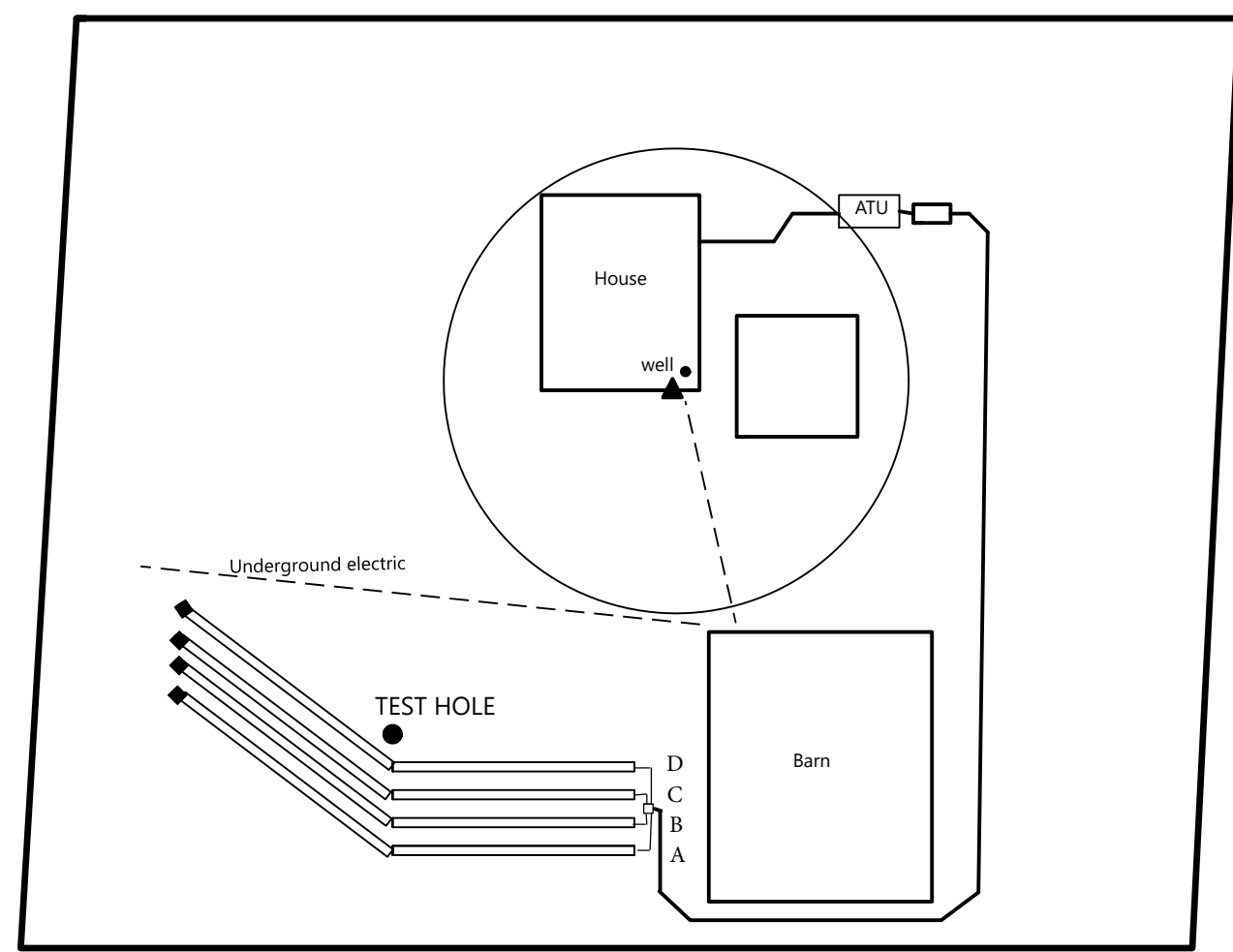

# 6319 S SR 53



© 2018 Pictometry

**APPROVED**

04/23/2018

OWNER NAME:	Thomas Snyder				
ADDRESS:	6319 S SR 53				
# BEDROOMS	3				
DAILY DESIGN FLOW	360				
ADJUSTMENTS:					
SYSTEM TYPE	ATU W/ liftstation to Leachfield				
<b>SOILS</b>					
LIMITING CONDITION	PSWT				
DEPTH TO LIMITING CONDITION	11"				
INFILTRATION DEPTH	8"				
DEPTH INTO ORIGINAL GRADE	3"				
SLOPE	0%				
	>25 mg/l	< 25 mg/l			
SOIL INFILTRATION LOADING RATE		0.6	Soil Horizon	Bt	
HYRAULIC LINEAR LOADING RATE		3.3	Soil Horizon	A	
<b>SYSTEM CALCULATIONS</b>					
INFILTRATIVE SURFACE (ft2)		600			
25% ADDITION FOR RESTING (ft2)		750			
25% REDUCTION FOR GRAVELLESS		NA			
MIN. INFILTRATIVE SURFACE (ACTIVE)		<b>562.5</b>			
MIN. INFILTRATIVE SURFACE (RESTING)		<b>187.5</b>			
MIN. INFILTRATIVE SURFACE (TOTAL)		<b>750</b>			
TRENCH LENGTH		109			
% TRENCH LENGTH REDUCTION		20%			
MIN. TRENCH LENGTH		87			
NUMBER OF TRENCHES		4			
ACTIVE LEACH TRENCHES		3			
RESTING LEACH TRENCHES		1			
<b>ACTUAL DESIGN</b>					
TRENCH WIDTH		2			
TRENCH LENGTH		108			
NUMBER OF TRENCHES		4			
TOTAL LINEAR FT. OF TRENCH		432			
TOTAL INFILTRATIVE SURFACE		864			
FIELD WIDTH		20 ft			
<b>MATERIALS:</b>					
1- 500 GPD ATU					
1- 1000 GAL LIFT STATION MODEL #1001			Pump run time 2.5 minutes/Pump off time 4 hrs		
108- LOW PROFILE 4FT CHAMBERS					
8- END CAPS					
40 FT- SCH 40 4" PIPE					
40 FT- SD SOLID PIPE 4"					
1- 8 HOLE D-BOX					
4- OBSERVATIONS PORTS					
4- Speed levelers					
280 FT- 2" SCH 40 PVC and misc. fittings					

APPROVED

LOCATION	FLOW LINE	ORIGINAL GRADE	FINISHED GRADE
1	5.3	3.3	3.3
2	6.8	5.3	5.3
3	7.1	5.3	5.3
4	7.15	5.2	5.2
5	6.9	5.2	5.2
6	2.4	2.8	1.8
7	2.6	2.8	1.8
	TRENCH BOTTOM	ORIGINAL GRADE	FINISHED GRADE
8			
A	2.9	2.7	1.7
B	2.9	2.8	1.8
C	3.1	2.8	1.8
D	3.1	2.9	1.9
9			
A	2.9	2.4	1.7
B	2.9	2.5	1.8
C	3.1	2.5	1.8
D	3.1	2.6	1.9
10			
A	2.9	2.1	1.7
B	2.9	2.3	1.8
C	3.1	2.3	1.8
D	3.1	2.4	1.9
BENCHMARK	SIL PLATE HOUSE	1	

**APPROVED**

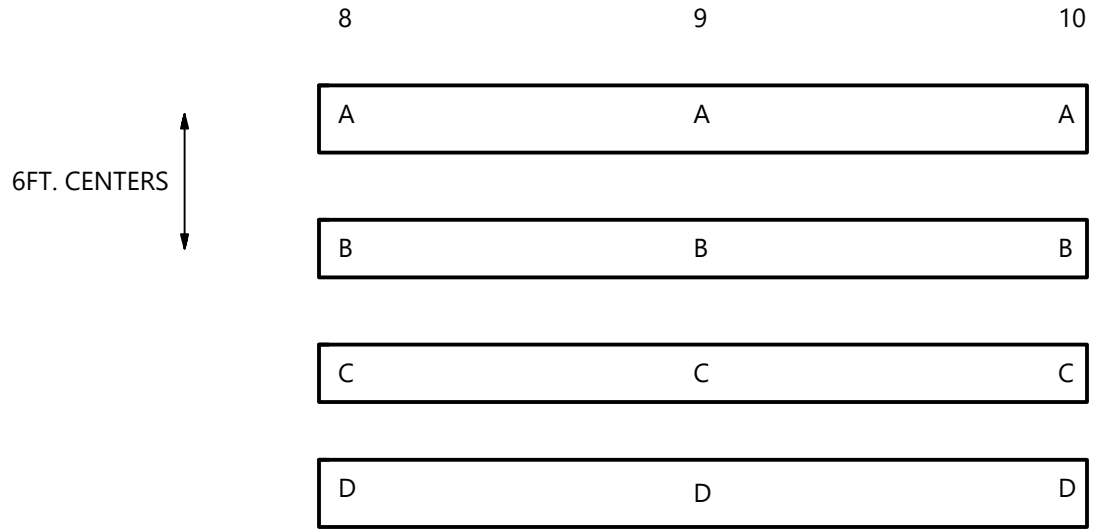
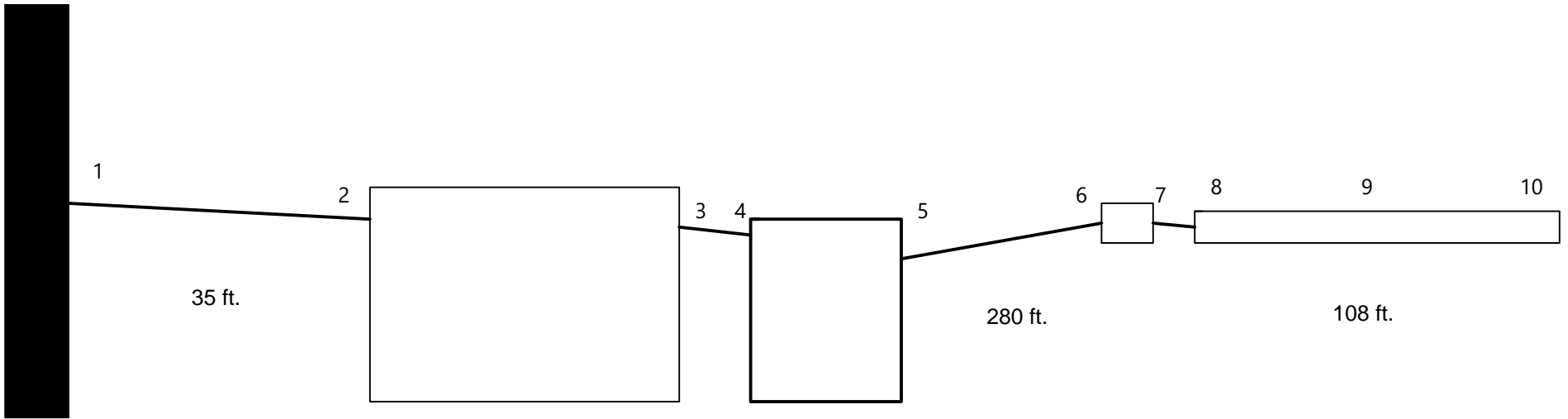

**APPROVED**

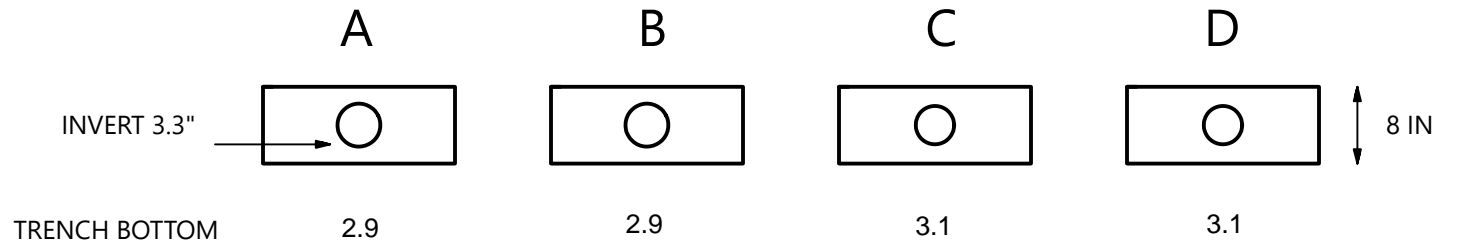

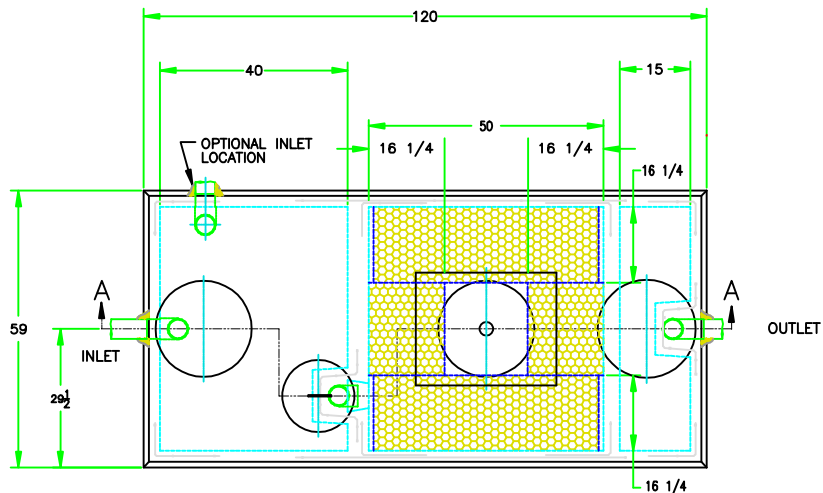

**NOTES:**

- 1.) AERATOR MODEL 700LL CONTINUOUS OPERATION MUST BE USED.
- 2.) IF AERATOR MOUNTING CASTING HAS NO RISER, RISERS ARE NOT REQUIRED HERE. REMOVABLE CONCRETE COVERS ARE REQUIRED.
- 3.) IF AERATOR MOUNTING CASTING HAS A RISER(S), COVERED RISERS ARE REQUIRED HERE. RISERS SHOULD BE DEVELOPED TO GRADE OR TO 6"–12" BELOW GRADE.

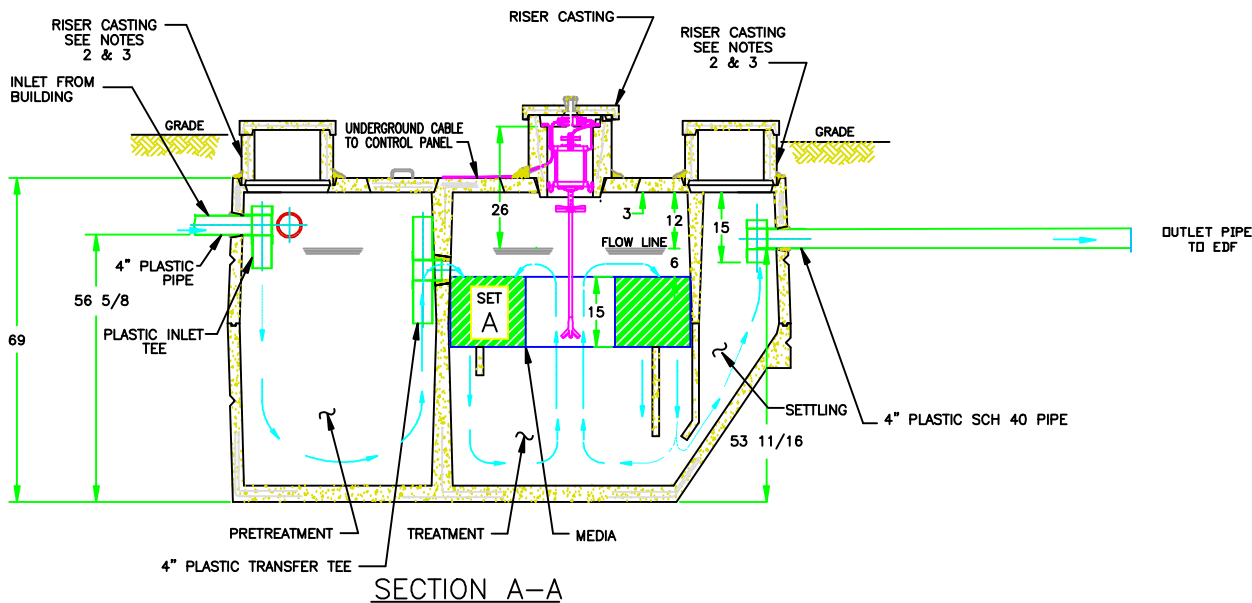

<b>J-T-INC.</b> CLEVELAND, OHIO <small>5000 sq. ft. of shop space</small>	DRAWN BY SDZ	DATE 08-26-08
	APPROVED BY THE WORKER	DATE 08-26-08
TITLE 500 GPD HOME PLANT	SCALE	UNLESS OTHERWISE SPECIFIED ALL DIMENSIONS IN INCHES DECIMALS & FRACTIONS ± 1/32"
USED ON PATENTED		WORKING NUMBER 080904

--	--	--	--	--	--	--	--	--	--	--	--	--	--	--	--	--	--	--

APPROVED

# 1/2 H.P. 1000 GAL LIFT STATION # 1001

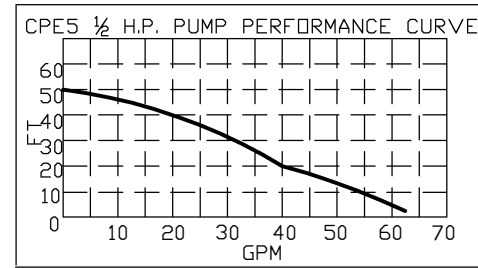
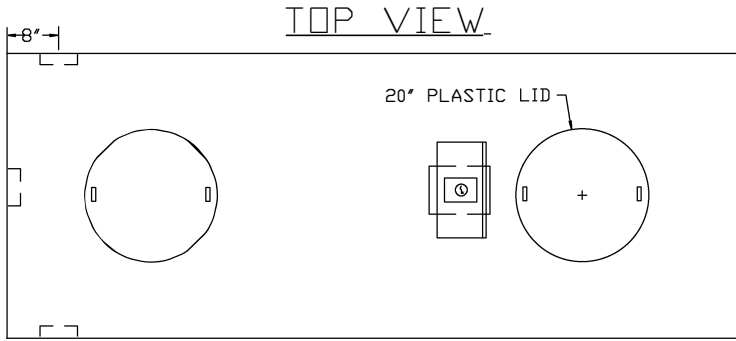

**FRONT VIEW  
W/INTERIOR DETAIL**

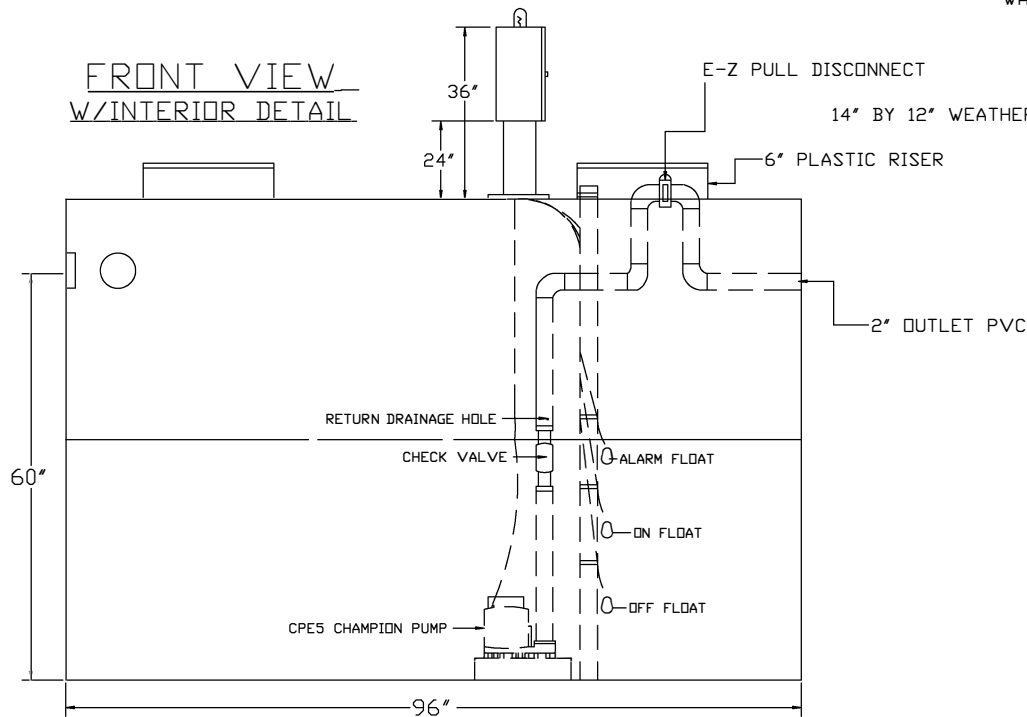

**SIDE VIEW**

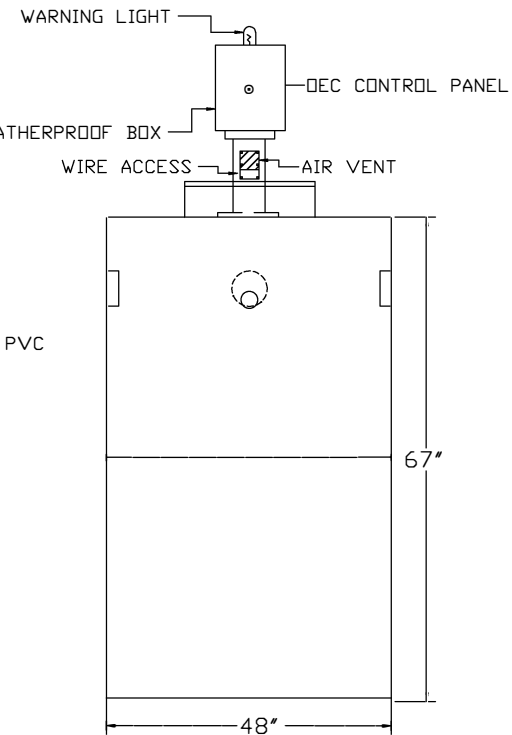

**General Notes**

48" WIDE  
96" LONG  
67" HIGH  
60" FROM CENTER OF INLET TO BOTTOM OF TANK

55" FROM CENTER OF OUTLET TO BOTTOM OF TANK

OFF FLOAT @ 15"

ON FLOAT @ 26"

ALM. FLOAT @ 36"

\*ALL MEASUREMENTS FROM BOTTOM OF TANK\*  
\*FOR EVERY INCH IT IS 10 GALLONS OF WATER\*

HIDDEN LINES

TWO PIECE TANK

THIS DOCUMENT IS PROPERTY OF STIGER PRECAST INC. AND MAY NOT BE REPRODUCED WITHOUT PERMISSION.

No.	Revision/Issue	Date
1	ADDITIONS/TJM	1/07

STIGER PRECAST INC.  
PHONE#  
740-482-2313  
800-426-2116

1000 GAL. LIFT STATION #1001  
1/2 H.P. TIME DOSE, AND BACK UP PUMPS AVAILABLE BY REQUEST

Project	1000	Sheet	L/S
Rev	05-05	Date	#1001
State	FULL		

TJM 2005

**APPROVED**



**INFILTRATOR®**  
water technologies

**Quick4<sup>PLUS</sup>**  
CHAMBER SYSTEMS

# The Quick4® Plus Equalizer 36 Low Profile (LP) Chamber

## Quick4 Plus™ Series

The Quick4 Plus Equalizer 36 Low Profile (LP) offers maximum strength through its two center structural columns. This chamber can be installed in a 24-inch-wide trench. It is 4 inches shorter in height than other Equalizer 36 model chambers, allowing for shallower installation. Like the original line of Quick4 chambers, it offers advanced contouring capability with its Contour Swivel Connection™, which permits turns up to 15°, right or left. The Quick4 Plus All-in-One 8 and Quick4 Plus Endcaps provide increased flexibility in system design and configurations.



**Maximum Strength**

### Quick4 Plus Equalizer 36 LP Chamber Specifications

**Size**

22"W x 53"L x 8"H  
(559 mm x 1346 mm x 203 mm)

**Effective Length**

48" (1219 mm)

**Louver Height**

6.3" (160 mm)

**Storage Capacity**

20 gal (76 L)

**Invert Height**

3.3" (84 mm), 9.6" (244 mm)



### Quick4 Plus Equalizer 36 Low Profile (LP) Chamber Benefits:

- Low profile design makes this chamber ideal for shallow applications
- Reduces imported fill needed for cap and fill systems
- Two center structural columns offer superior strength
- Advanced contouring connections
- Latching mechanism allows for quick installation
- Four-foot chamber lengths are easy to handle and install
- Supports wheel loads of 16,000 lbs/axle with 12" of cover

### Quick4 Plus All-in-One Periscope Benefits:

- Allows for raised invert installations
- 180° directional inletting
- 12" raised invert is ideal for serial applications



### Quick4 Plus All-in-One 8 Endcap Benefits:

- May be used at the end of chamber row for an inlet/outlet or can be installed mid-trench
- Mid-trench connection feature allows center feed inletting of chamber rows
- Center-feed connection allows for easy installation of serial distribution systems
- Variable pipe connection options allow for side, end or top inletting
- Piping drill points are set for gravity or pressure pipe

### Quick4 Plus Endcap Benefits:

- Simple, flat design
- Allows installation of a pipe from the end only
- Piping drill points are set for gravity or pressure pipe



Certified by the International Association of Plumbing and Mechanical Officials (IAPMO)





**Quick4 Plus Equalizer 36 Low Profile Chamber**

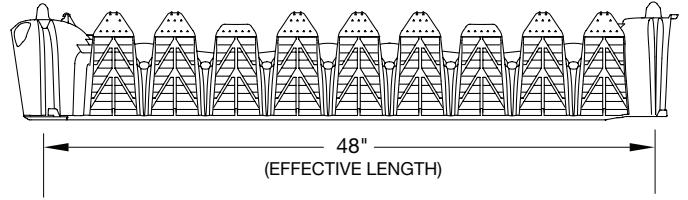
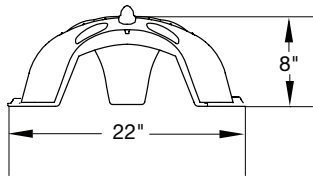

**Quick4 Plus All-in-One 8 Endcap**

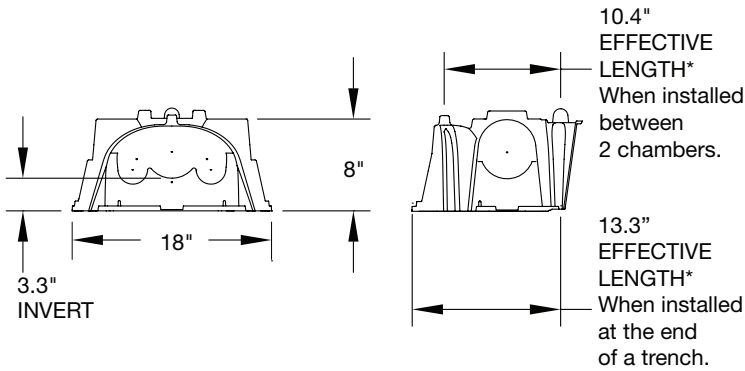

**Quick4 Plus Endcap**

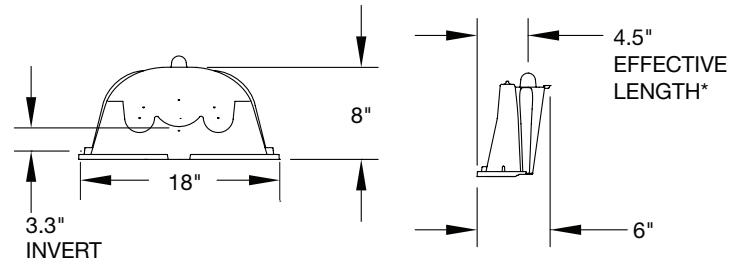

**Quick4 Plus All-in-One Periscope**

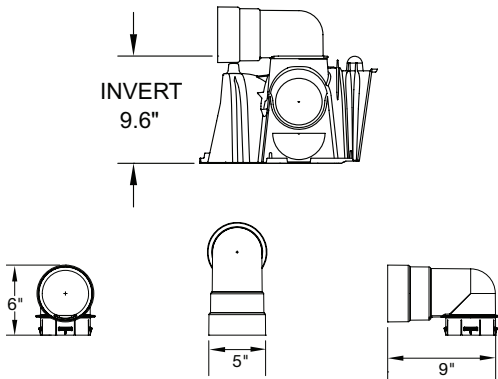

**INFILTRATOR WATER TECHNOLOGIES STANDARD LIMITED WARRANTY**

(a) The structural integrity of each chamber, endcap and other accessory manufactured by Infiltrator ("Units"), when installed and operated in a leachfield of an onsite septic system in accordance with Infiltrator's instructions, is warranted to the original purchaser ("Holder") against defective materials and workmanship for one year from the date that the septic permit is issued for the septic system containing the Units; provided, however, that if a septic permit is not required by applicable law, the warranty period will begin upon the date that installation of the septic system commences. To exercise its warranty rights, Holder must notify Infiltrator in writing at its Corporate Headquarters in Old Saybrook, Connecticut within fifteen (15) days of the alleged defect. Infiltrator will supply replacement Units for Units determined by Infiltrator to be covered by this Limited Warranty. Infiltrator's liability specifically excludes the cost of removal and/or installation of the Units.

(b) THE LIMITED WARRANTY AND REMEDIES IN SUBPARAGRAPH (a) ARE EXCLUSIVE. THERE ARE NO OTHER WARRANTIES WITH RESPECT TO THE UNITS, INCLUDING NO IMPLIED WARRANTIES OF MERCHANTABILITY OR FITNESS FOR A PARTICULAR PURPOSE

(c) This Limited Warranty shall be void if any part of the chamber system is manufactured by anyone other than Infiltrator. The Limited Warranty does not extend to incidental, consequential, special or indirect damages. Infiltrator shall not be liable for penalties or liquidated damages, including loss of production and profits, labor and materials, overhead costs, or other losses or expenses incurred by the Holder or any third party. Specifically excluded from Limited Warranty coverage are damage to the Units due to ordinary wear and tear, alteration, accident, misuse, abuse or neglect of the Units; the Units being subjected to vehicle traffic or other conditions which are not permitted by the installation instructions; failure to maintain the minimum ground covers set forth in the installation instructions; the placement of improper materials into the system containing the Units; failure of the Units or the septic system due to improper siting or improper sizing, excessive water usage, improper grease disposal, or improper operation; or any other event not caused by Infiltrator. This Limited Warranty shall be void if the Holder fails to comply with all of the terms set forth in this Limited Warranty. Further, in no event shall Infiltrator be responsible for any loss or damage to the Holder, the Units, or any third party resulting from installation or shipment, or from any product liability claims of Holder or any third party. For this Limited Warranty to apply, the Units must be installed in accordance with all site conditions required by state and local codes; all other applicable laws; and Infiltrator's installation instructions.

(d) No representative of Infiltrator has the authority to change or extend this Limited Warranty. No warranty applies to any party other than the original Holder.

The above represents the Standard Limited Warranty offered by Infiltrator. A limited number of states and counties have different warranty requirements. Any purchaser of Units should contact Infiltrator's Corporate Headquarters in Old Saybrook, Connecticut, prior to such purchase, to obtain a copy of the applicable warranty, and should carefully read that warranty prior to the purchase of Units.



4 Business Park Road  
P.O. Box 768  
Old Saybrook, CT 06475  
860-577-7000 • Fax 860-577-7001  
**1-800-221-4436**  
[www.infiltratorwater.com](http://www.infiltratorwater.com)

U.S. Patents: 4,759,661; 5,017,041; 5,156,488; 5,336,017; 5,401,116; 5,401,459; 5,511,903; 5,716,163; 5,588,778; 5,839,844 Canadian Patents: 1,329,959; 2,004,564 Other patents pending. Infiltrator, Equalizer, Quick4, and SideWinder are registered trademarks of Infiltrator Water Technologies. Infiltrator is a registered trademark in France. Infiltrator Water Technologies is a registered trademark in Mexico. Contour, MicroLeaching, PolyTuff, ChamberSpacer, MultiPort, PosiLock, QuickCut, QuickPlay, SnapLock and StraightLock are trademarks of Infiltrator Water Technologies. PolyLok is a trademark of PolyLok, Inc. TUF-TITE is a registered trademark of TUF-TITE, INC. Ultra-Rib is a trademark of IPEX Inc.

© 2013 Infiltrator Water Technologies, LLC. All rights reserved. Printed in U.S.A.

PLUS06 0713

**Contact Infiltrator Water Technologies' Technical Services Department for assistance at 1-800-221-4436**

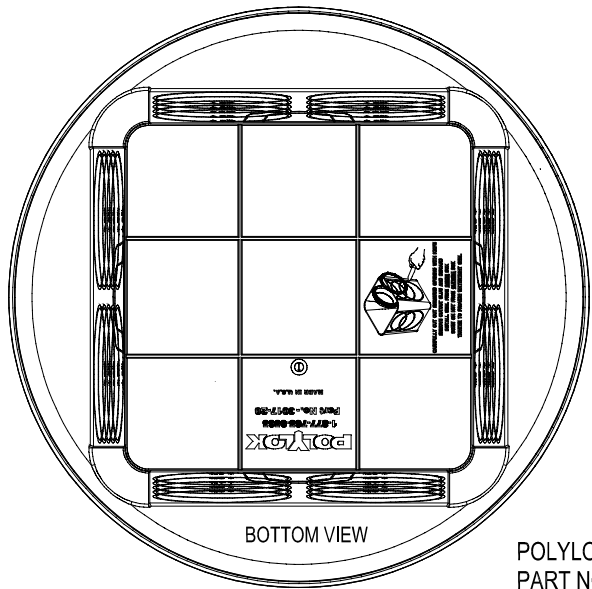

BOTTOM VIEW

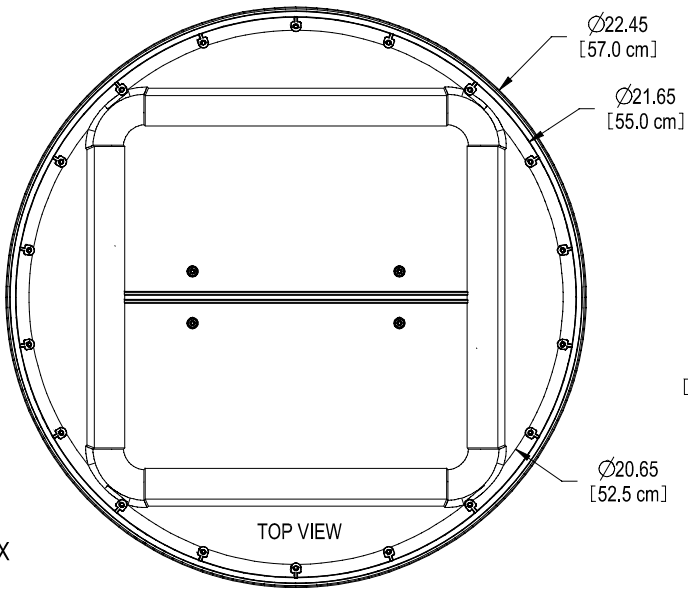

TOP VIEW

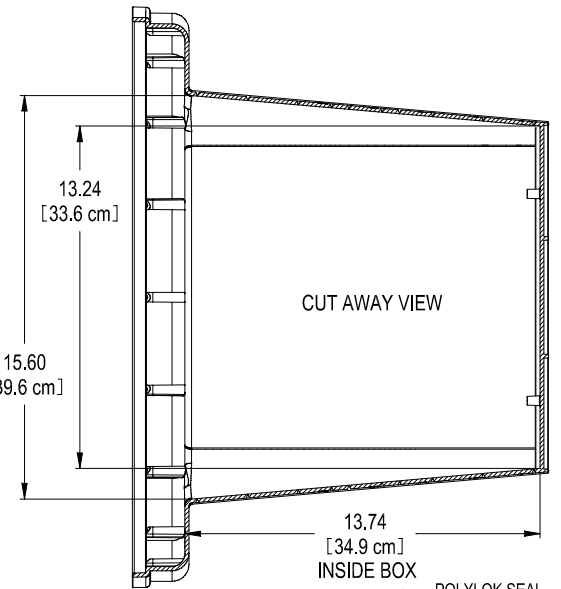

CUT AWAY VIEW

INSIDE BOX

POLYLOK 20" D-BOX  
 PART NO. 3017-20  
 MATERIAL - POLYPROPYLENE  
 COLOR - BLACK  
 CAPACITY - 15 GALLONS

BOX ACCEPTS:  
 LIGHT COVER PART NO. - 3009C  
 HEAVY COVER PART NO. -3017-C20  
 GRATE- PART NO. -3017-G20  
 6" TALL RISER PART NO. 3009  
 12" TALL RISER PART NO. 3009-R12

POLYLOK SEAL ASSEMBLY PART NO. 3001 (4 SEAL ASSEMBLIES INCLUDED)

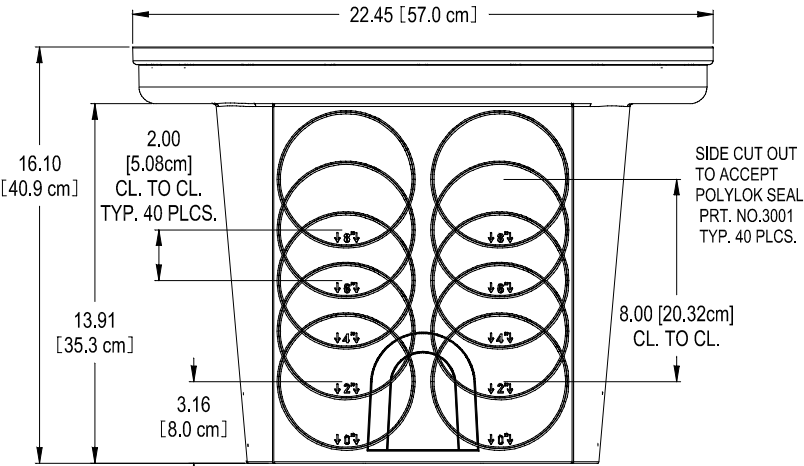
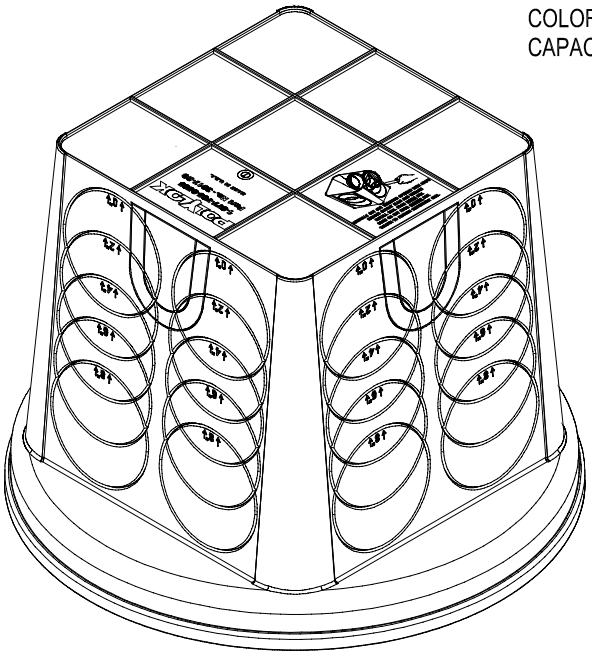

FRONT/SIDE VIEW

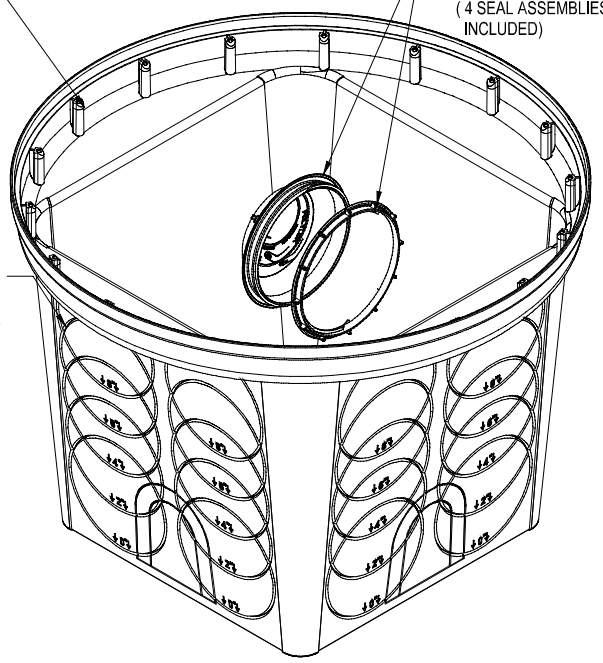



# Speed Levelers™



## There Is No Faster, Easier, Better, Or More Economical Way To Equalize Distribution Box Flow

There's no need to dig up and re-level tilted distributions boxes. Or to struggle with makeshift pipe dams. Now, with Tuf-Tite Speed Levelers, you can do the job in a fraction of the time, for a fraction of the cost.



For all size and shape concrete distributions boxes, as well as polyethylene boxes from Tuf-Tite.

### Tough Problem

The distribution box is out of alignment. Effluent does not flow equally into the outlet pipes.

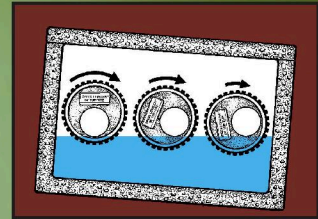

### TUF-TITE Solution

Insert Tuf-Tite Speed Levelers into the outlet pipes. Simply adjust each Leveler so the flow is equally distributed.



### For 3" or 4" PVC pipes

Speed Levelers are precision engineered to fit commonly used Schedule 40 Thick-Wall, SDR 35 (3034), and 2729 Thin-Wall PVC pipes. Simply press the Levelers into the pipe ends. They fit water-tight. No tools are necessary.

### Non-corrosive Polyethylene

Tuf-Tite Speed Levelers are molded of specially formulated polyethylene that is highly chemical resistant. They are actually more corrosion resistant than the PVC pipe in which they're used.



### They're hand-adjustable

Easily rotate Speed Levelers by hand. The Flo-Hole can be positioned to admit effluent at the precise level you desire. The range of settings is infinitely variable. And Levelers can be reset easily, anytime.

### Tested. Proved. Preferred

Test after test show that Tuf-Tite Speed Levelers significantly improve distribution in gravity-flow septic systems. There simply is no other way this can be accomplished as effectively, quickly, easily, or economically.

# Site/Soil Evaluation For Home Septic Treatment System (HSTS) Suitability By Geophyta, Inc.

This site/soil evaluation, prepared by Geophyta Inc., is for information purposes to be used by a landowner, septic system designer, and your local health department. Geophyta provides technical information to help identify limits for an HSTS on a parcel to be used as a home site. Geophyta serves as a technical advisor for soils/site information.

Geophyta relies on accurate information provided by the landowner and technical data collected by Geophyta. This information includes local soil limits and topography, plus existing and future locations of your home, number of bedrooms, out buildings, driveways, drinking water wells, ponds, existing septic systems, and property lines. Geophyta Inc. relies on this information to make accurate recommendations.

This is not a property boundary survey.

This is not a septic system design. You must use a septic system designer to prepare a complete design to be submitted to your local health department for approval.

**This report does not guarantee buildability of a lot or approval of any septic system design. Your county health department is the final authority on approval of any septic system design and most likely will not make a buildability decision without a full design package.**

Sincerely,

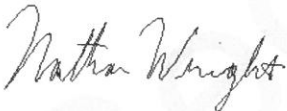

Nathan Wright  
Geophyta, Inc.

## Site and Soil Evaluation for Sewage Treatment and Dispersal

County: Seneca  
 Township / Sec.: Seneca  
 Property Address: 6319 S. S.R. 53  
 OR Location: Tiffin  
 Applicant Name: Judy & Tom Snyder  
 Address: 6319 S. S.R. 53  
Tiffin OH 44883  
 Phone #: 419-448-9996  
 Lot #: \_\_\_\_\_  
 Test Hole #: B  
 Latitude/Longitude: 83°13'51.267"W 41°1'53.398"N  
 Method:          Pit          Auger X Probe; 1 1/4" dia.

Land Use / Vegetation: Residential Turf  
 Landform: Glacial Till Plain  
 Position on Landform: Hillslope  
 Percent Slope: 1 - 2  
 Shape of Slope: Linear - Linear  
 Approximate Soil Type: Haskins L

Date: 30-Jul-19  
 Evaluator: Nathan Wright  
Geophyta, Inc.  
2685 C.R. 254  
Vickery, OH 43464  
 Phone#: 419-547-8538

Control #: 19- SEN - 21B - 181  
 Certification #: \_\_\_\_\_  
 Signature: \_\_\_\_\_



Soil Profile	Depth (inches)	Estimating Soil Saturation				Estimating Soil Permeability				Other Soil Features		
		Matrix Color	Redoximorphic Features	Depletions	Class	Texture		Structure				
						Approx. % Clay	Approx. % Fragments	Grade	Size		Type (shape)	Consistence
A	0.0 - 11.5	10YR 3/3	none	none	L	20	0	2-mod	fine	sbk	friable	
Bt	11.5 - 27.0	10YR 5/4	none	15% 10YR 5/2	SICL	30	0	2-mod	medium	sbk	firm	
C	27.0 - 48.0	10YR 4/6	none	25% 10YR 6/1	SICL	35	5	1-weak	medium	sbk	firm	
Limiting Conditions		Depth to (in.)	Descriptive Notes		Remarks / Risk Factors:							
Perched Seasonal Water Table		11.5	Restricted in Bt and C									
Apparent Water Table		>48										
Highly Permeable Material		>48										
Bedrock		>60	By Tile Probe									
Other Restrictive Layer		>48										

Note : The evaluation shall include a complete site plan or site drawing including all requirements in paragraphs (B)(1) through (B)(4) of OAC 3701-29-08.

## Site and Soil Evaluation for Sewage Treatment and Dispersal

County: Seneca Land Use / Vegetation: Residential Turf Control # 19- SEN - 21A - 181

Township / Sec.: Seneca Landform: Glacial Till Plain

Property Address: 6319 S. S.R. 53 Position on Landform: Hillslope

OR Location: Tiffin Percent Slope: 1 - 2

Applicant Name: Judy & Tom Snyder Shape of Slope: Linear - Linear

Address: 6319 S. S.R. 53 Approximate Soil Type: Haskins L

Tiffin OH 44883 Date: 30-Jul-19

Phone #: 419-448-9996 Evaluator: Nathan Wright

Lot #: \_\_\_\_\_ Geophyta, Inc.

Test Hole #: A 2685 C.R. 254

Latitude/Longitude: 83°13'49.478"W 41°1'53.898"N Vickery, OH 43464

Method:          Pit          Auger   X   Probe; 1 1/4" dia. Phone #: 419-547-8538

Signature:  Certification #: 19395



APPROVED

Soil Profile	Estimating Soil Saturation					Estimating Soil Permeability						
	Depth (inches)	Matrix Color	Concentrations	Depletions	Munsell Color (hue, value, chroma)	Texture		Structure			Other Soil Features	
						Approx. % Clay	Approx. % Fragments	Grade	Size	Type (shape)		Consistence
<b>A</b>	<b>0.0 - 11.0</b>	<b>10YR 3/2</b>	<b>none</b>	<b>none</b>	<b>L</b>	<b>20</b>	<b>0</b>	<b>2-mod</b>	<b>medium</b>	<b>sbk</b>	<b>friable</b>	
<b>Bt</b>	<b>11.0 - 24.0</b>	<b>10YR 4/4</b>	<b>none</b>	<b>25% 10YR 5/2</b>	<b>SicL</b>	<b>30</b>	<b>0</b>	<b>2-mod</b>	<b>fine</b>	<b>sbk</b>	<b>firm</b>	
<b>C</b>	<b>24.0 - 48.0</b>	<b>10YR 5/4</b>	<b>none</b>	<b>20% 10YR 5/1</b>	<b>SicL</b>	<b>35</b>	<b>5</b>	<b>1-weak</b>	<b>medium</b>	<b>sbk</b>	<b>firm</b>	
Limiting Conditions		Depth to (in.)	Descriptive Notes		Remarks / Risk Factors:							
Perched Seasonal Water Table		<b>11.0</b>	Restricted in Bt and C									
Apparent Water Table		<b>&gt;48</b>										
Highly Permeable Material		<b>&gt;48</b>										
Bedrock		<b>&gt;60</b>	By Tile Probe									
Other Restrictive Layer		<b>&gt;48</b>										

Note: The evaluation shall include a complete site plan or site drawing including all requirements in paragraphs (B)(1) through (B)(4) of OAC 3701-29-08.

ODH - Dec 2006 - Revised Sept 2007 - Modified By Geophyta, Inc.

# HSTS Site/Soil Evaluation - 6319 S. S.R. 53

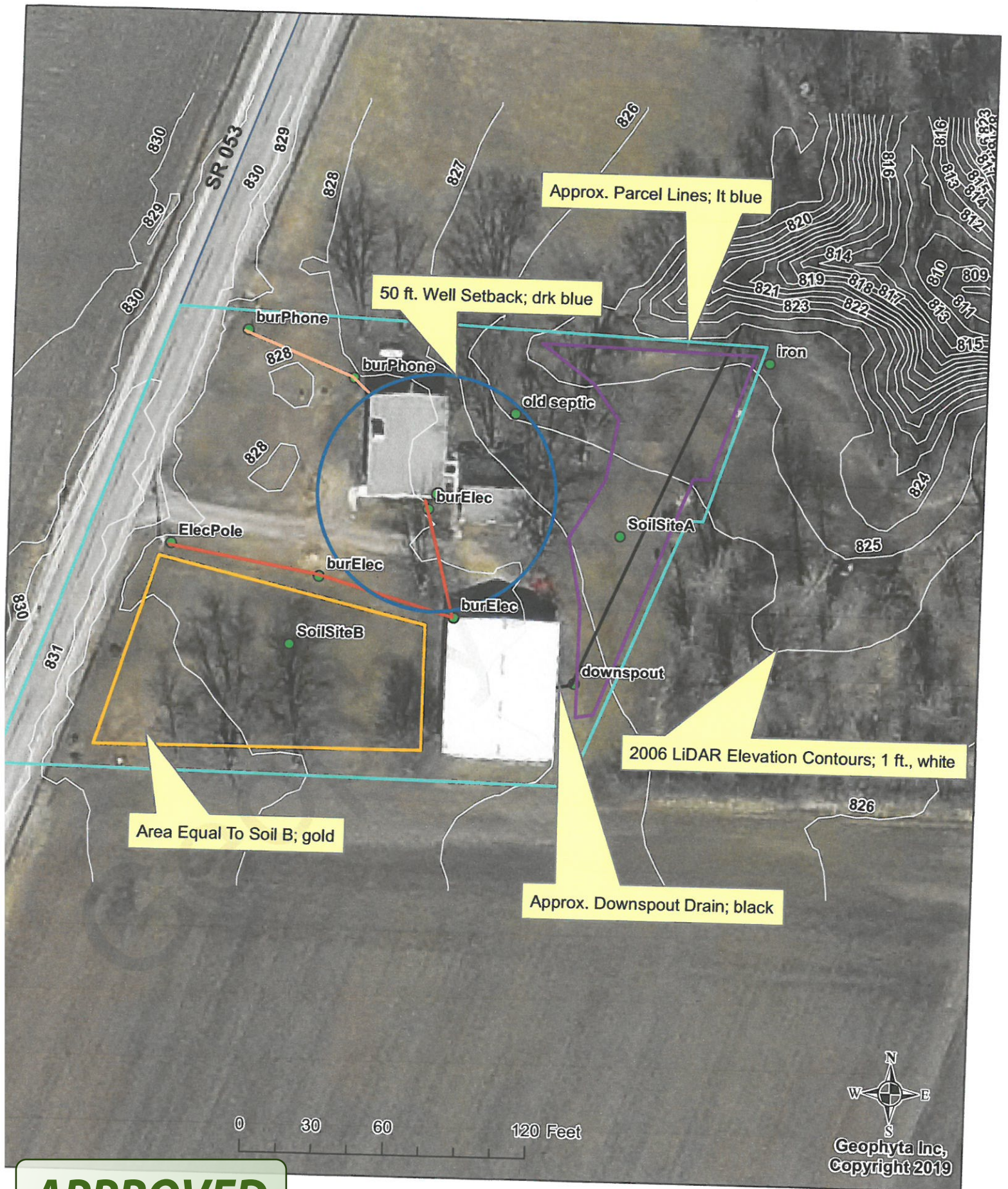

**APPROVED**